

TUBE BRUSHES

APERTUER CLEANING TUBE BRUSHES

TI-Type

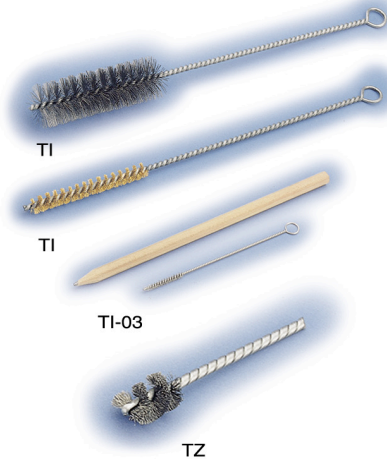

ITEM NO.	Diameter D m/m-inch	Length L m/m	Overall Length AL m/m	CODE NO.			
				Steel	Brass	Stainless	Nylon
				TI-Type	TIB-Type	TIS-Type	TIN-Type
TI-03	3m/m - 1/8"	25	100	185-031	185-032	185-033	185-035
TI-05	5m/m - 3/16"	25	100	185-051	185-052	185-053	185-055
TI-06	6m/m - 1/4"	50	150	185-061	185-062	185-063	185-065
TI-08	8m/m - 5/16"	50	150	185-081	185-082	185-083	185-085
TI-10	10m/m - 3/8"	80	250	185-101	185-102	185-103	185-105
TI-13	13m/m - 1/2"	80	250	185-131	185-132	185-133	185-135
TI-16	16m/m - 5/8"	80	250	185-161	185-162	185-163	185-165
TI-19	19m/m - 3/4"	80	250	185-191	185-192	185-193	185-195
TI-25	25m/m - 1"	80	250	185-251	185-252	185-253	185-255
TI-32	32m/m - 1 1/4"	80	250	185-321	185-322	185-323	185-325

INTERIOR BRUSHES

TZ-Type

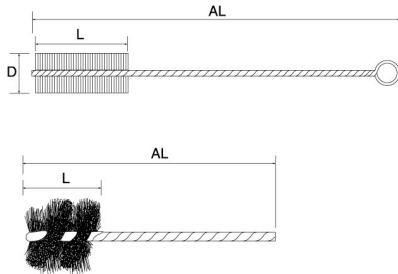

ITEM NO.	Diameter D m/m-inch	Length L m/m	Overall Length AL m/m	CODE NO.			
				Steel	Brass	Stainless	Nylon
				TZ-Type	TZB-Type	TZS-Type	TZN-Type
TZ-08	8m/m - 5/16"	20	85	186-081	186-082	186-083	186-085
TZ-10	10m/m - 3/8"	20	85	186-101	186-102	186-103	186-105
TZ-16	16m/m - 5/8"	20	85	186-161	186-162	186-163	186-165
TZ-19	19m/m - 3/4"	20	85	186-191	186-192	186-193	186-195
TZ-25	25m/m - 1"	20	85	186-251	186-252	186-253	186-255
TZ-32	32m/m - 1 1/4"	20	85	186-321	186-322	186-323	186-325



All kinds of sizes materials are available for custom-made.

POLISHING BRUSHES

For very light polishing

STAINLESS WIRE BRUSHES

PWS-Type

BRASS WIRE BRUSHES

PWB-Type



PWS



PWH



PWT

ITEM NO.	Diameter D m/m-inch	Width W m/m	CODE NO.		MAX. RPM	Remark
			Stainless 0.13 m/m			
PWS-60	150m/m - 6"	25m/m - 1"	514-612	6000		
		50m/m - 2"	514-622	6000		
		100m/m - 4"	514-642	6000		
PWS-70	178m/m - 7"	25m/m - 1"	514-712	4500		
		50m/m - 2"	514-722	4500		
		100m/m - 4"	514-742	4500		
PWS-80	200m/m - 8"	25m/m - 1"	514-812	4500		
		50m/m - 2"	514-822	4500		
		100m/m - 4"	514-842	4500		

ITEM NO.	Diameter D m/m-inch	Width W m/m	CODE NO.		MAX. RPM	Remark
			Brass 0.13 m/m			
PWB-60	150m/m - 6"	25m/m - 1"	514-613	6000		
		50m/m - 2"	514-623	6000		
		100m/m - 4"	514-643	6000		
PWB-70	178m/m - 7"	25m/m - 1"	514-713	4500		
		50m/m - 2"	514-723	4500		
		100m/m - 4"	514-743	4500		
PWB-80	200m/m - 8"	25m/m - 1"	514-813	4500		
		50m/m - 2"	514-823	4500		
		100m/m - 4"	514-843	4500		

HORSE HAIR BRUSHES

PWH-Type

TEMPICO FIBER BRUSHES

PWT-Type

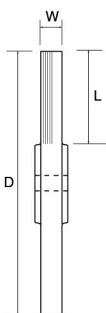

ITEM NO.	Diameter D m/m-inch	Width W m/m	CODE NO.		MAX. RPM	Remark
			Horse Hair			
PWH-60	150m/m - 6"	25m/m - 1"	514-617	6000		
		50m/m - 2"	514-627	6000		
		100m/m - 4"	514-647	6000		
PWH-70	178m/m - 7"	25m/m - 1"	514-717	4500		
		50m/m - 2"	514-727	4500		
		100m/m - 4"	514-747	4500		
PWH-80	200m/m - 8"	25m/m - 1"	514-817	4500		
		50m/m - 2"	514-827	4500		
		100m/m - 4"	514-847	4500		

ITEM NO.	Diameter D m/m-inch	Width W m/m	CODE NO.		MAX. RPM	Remark
			Tempico Fiber			
PWT-60	150m/m - 6"	25m/m - 1"	514-618	6000		
		50m/m - 2"	514-628	6000		
		100m/m - 4"	514-648	6000		
PWT-70	178m/m - 7"	25m/m - 1"	514-718	4500		
		50m/m - 2"	514-728	4500		
		100m/m - 4"	514-748	4500		
PWT-80	200m/m - 8"	25m/m - 1"	514-818	4500		
		50m/m - 2"	514-828	4500		
		100m/m - 4"	514-848	4500		